

SCHOTTKY BARRIER DIODE

• APPLICATIONS

1) Low-power rectification

• FEATURES

- 1) Small surface mounting type SC-76/SOD323.
- 2) Low reverse current and low voltage.
- 3) High reliability
- 4) We declare that the material of product compliant with RoHS requirements and Halogen Free.
- 5) S- Prefix for Automotive and Other Applications Requiring Unique Site and Control Change Requirements; AEC-Q101 Qualified and PPAP Capable.

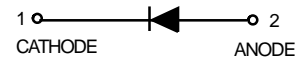

DEVICE MARKING AND ORDERING INFORMATION

Device	Marking	Shipping
RB5712	5E	3000/Tape&Reel

MAXIMUM RATINGS(Ta = 25°C)

Parameter	Symbol	Limits	Unit
Peak reverse voltage	V _{RM}	40	V
DC reverse voltage	V _R	30	V
Mean rectifying current	I _O	30	mA
Peak forward surge current	I _{FSM}	200	mA
Junction temperature	T _j	125	°C
Storage temperature	T _{stg}	-40 ~ +125	°C

ELECTRICAL CHARACTERISTICS (Ta= 25°C)

Parameter	Symbol	Min.	Typ.	Max.	Unit	Conditions
Forward voltage	V _F	–	–	0.37	V	I _F =1mA
Reverse current	I _R	–	–	0.5	μA	V _R =30V
Capacitance between terminals	C _T	–	2	–	pF	V _R =1V, f=1MHz

ELECTRICAL CHARACTERISTIC CURVES

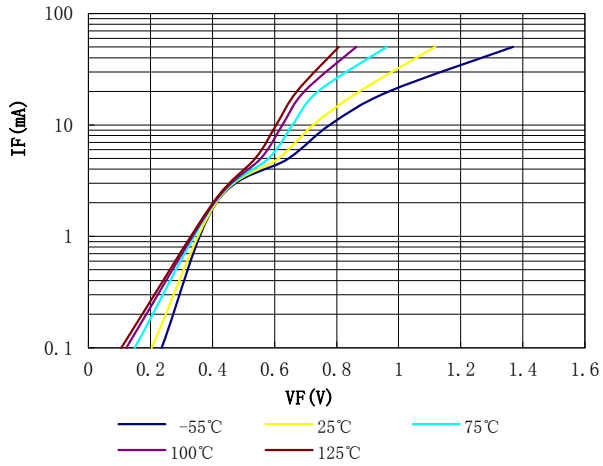

Fig 1. Forward character

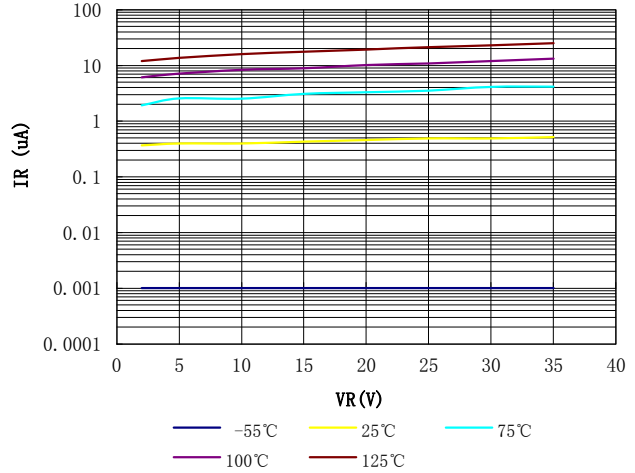

Fig 2. Reverse character

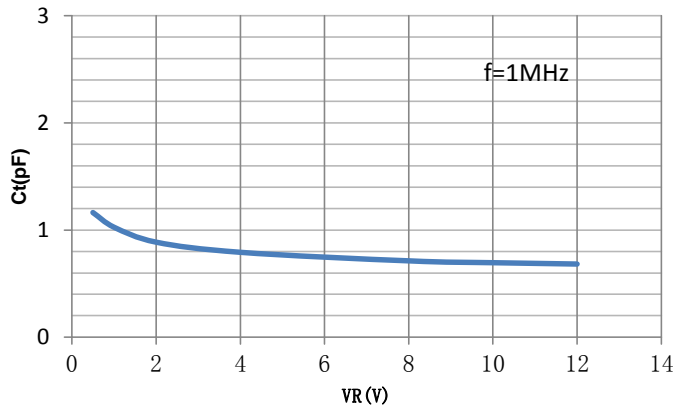
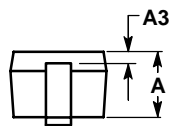
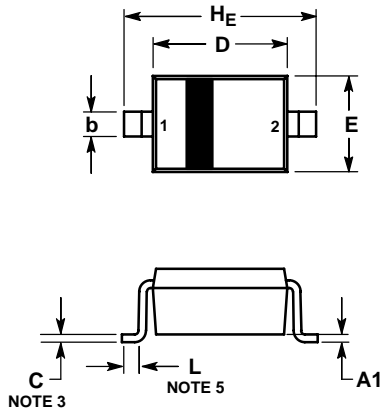

Fig 3. Capacitance character

SOD-323



DIM	MILLIMETERS			INCHES		
	MIN	NOM	MAX	MIN	NOM	MAX
A	0.80	0.90	1.00	0.031	0.035	0.040
A1	0.00	0.05	0.10	0.000	0.002	0.004
A3	0.15 REF			0.006 REF		
b	0.25	0.32	0.4	0.010	0.012	0.016
C	0.089	0.12	0.177	0.003	0.005	0.007
D	1.60	1.70	1.80	0.062	0.066	0.070
E	1.15	1.25	1.35	0.045	0.049	0.053
L	0.08			0.003		
HE	2.30	2.50	2.70	0.090	0.098	0.105

SOLDERING FOOTPRINT*

